

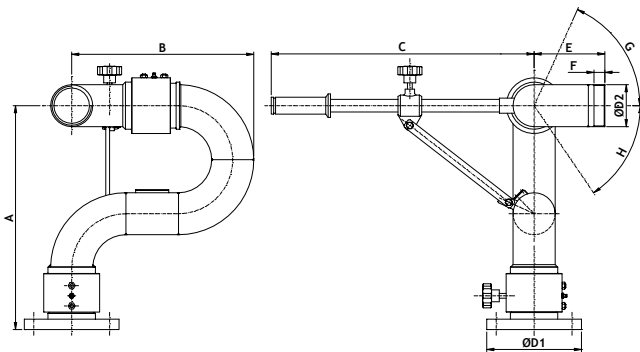





Monitor Equipment | Manual Monitor | ML Lever Operated Monitor



SPECIFICATIONS	
Related documents	None available
Approvals	  
Material (Body)	Stainless steel AISI 316
Material (Joints)	Stainless steel AISI 316, Phosphor bronze balls
Material (Flange)	Carbon or stainless steel
Working pressure (Max.)	16 bar*
Finish	Red epoxy (Flame red RAL3000)
Connection type	Flange PN16
Rotation	360° continuous
Swivels	Vertical (Lever) Horizontal (Knob)
Options	<ul style="list-style-type: none"> <li>Polished stainless steel finish</li> <li>ANSI flanges</li> </ul>
Weight	See table
<p><b>* Note:</b> Lower working pressures may need to be assessed based upon how the monitor is operated, supported and where installed. Please refer to recoil force table for further information.</p>	

Part number*	A (mm)	B (mm)	C (mm)	ØD1 (inch) PN16	Flange material	ØD2 (inch) BSP	E (mm)	F (mm)	G (°)	H (°)	Max. flow rate (l/min)	Weight (kg)
<b>2.5" Stainless steel body</b>												
EML2-25X3CPS	400	330	360	3"	Carbon steel	2-1/2"	145	21	85	65	2,000	16.0
EML2-25X3SPS	400	330	360	3"	Stainless steel	2-1/2"	145	21	85	65	2,000	16.0
EML2-25X4CPS	400	330	360	4"	Carbon steel	2-1/2"	145	21	85	65	2,000	16.0
EML2-25X4SPS	400	330	360	4"	Stainless steel	2-1/2"	145	21	85	65	2,000	16.0
<b>3" Stainless steel body</b>												
EML2-3X3CPS	475	385	640	3"	Carbon steel	3"	150	23	70	55	4,000	20.0
EML2-3X3SPS	475	385	640	3"	Stainless steel	3"	150	23	70	55	4,000	20.0
EML2-3X4CPS	475	385	640	4"	Carbon steel	3"	150	23	70	55	4,000	20.0
EML2-3X4SPS	475	385	640	4"	Stainless steel	3"	150	23	70	55	4,000	20.0
<b>4" Stainless steel body</b>												
EML2-4X3CPS	590	473	775	4"	Carbon steel	4" PN16	200	25	70	45	8,000	30.0
EML2-4X3SPS	590	473	775	4"	Stainless steel	4" PN16	200	25	70	45	8,000	30.0
EML2-4X4CPS	590	473	775	6"	Carbon steel	4" PN16	200	25	70	45	8,000	30.0
EML2-4X4SPS	590	473	775	6"	Stainless steel	4" PN16	200	25	70	45	8,000	30.0

\*For polished stainless steel finish - substitute final "S" of part number with an "X" (Example EML2-4X6SPX)

Note: This document contains basic product information only. Information, photos and drawings are not contractually binding. In all cases, the manufacturer's full technical documentation (see "Related Documents" above) remains the reference document. Note that certificates, test reports and approvals may be published in the OEM name. The contents of this publication are subject to modifications without notice. All rights reserved

Trusted above all.

